

FILTER OVERVIEW AND FUEL PUMP

LX029862 -UN-

6000

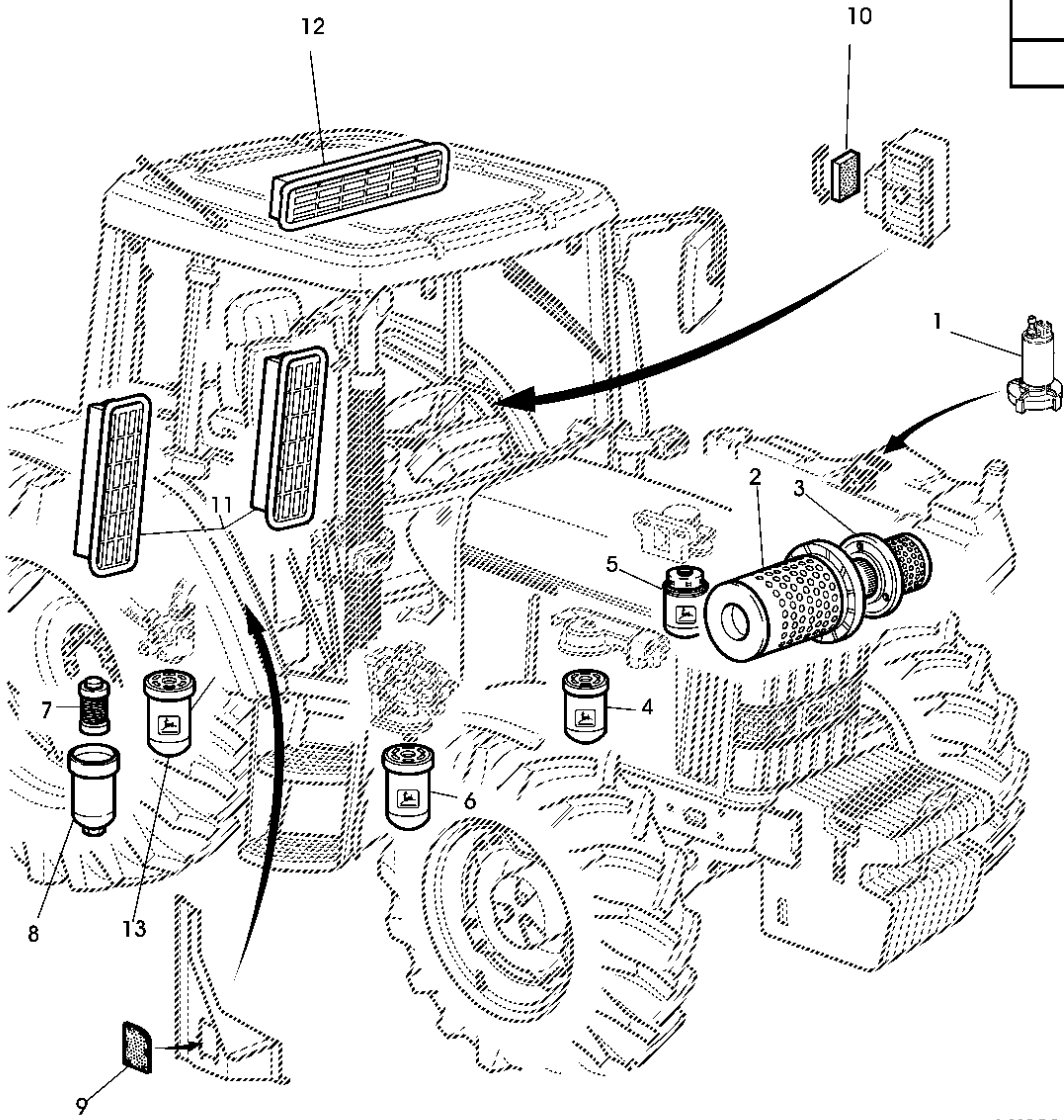

LX029862

KEY	PART NO.	PART NAME	QTY.	TRACTOR SERIAL NO.	4 6 C C Y Y L L	REMARKS
1	AL78405	FUEL PUMP	1		X X	
2	AL78223	FILTER ELEMENT	1		X	
	AL78869	FILTER ELEMENT	1		X	
3	AL78224	AIR FILTER	1		X	
	AL78870	FILTER ELEMENT	1		X	
4	T19044	OIL FILTER	1		X X	
5	RE62419	FILTER ELEMENT	1		X X	A=109MM (4.3") (SUB FOR RE62418, RE64450 APPL)
6	AL156625	OIL FILTER	1		X X	LGTH=158MM, FRONT (SUB FOR AL77061)
	AL156624	OIL FILTER	1		X	LGTH=120MM
7	AL203060	OIL FILTER	1		X X	(E) LGTH=205MM (SUB FOR AL113475, AL112936)
8	AL112922	FILTER HOUSING	1		X X	(E) LGTH=240MM (SUB FOR AL113474)
9	L101786	FILTER ELEMENT	2		X X	(B) (C)
10	L101794	FILTER ELEMENT	2		X X	(B) (C)
11	AL177185	AIR FILTER	2		X X	(B) (C) (F) (SUB FOR AL111748, AL115625, AL119096)
	AL177184	AIR FILTER	2		X X	(SUB FOR AL119095)
12	AL177185	AIR FILTER	1		X X	(D) (F) (SUB FOR AL111748, AL115625, AL119096)
	AL177184	AIR FILTER	1		X X	(SUB FOR AL119095)
13	AL118036	HYDRAULIC FILTER	1		X X	(A) REAR, LGTH=240MM (SUB FOR RE34958 APPL)

(A) WITH 25 CM3 HYDRAULIC PUMP

(B) WITH CAB

(C) NOT FOR SE TRACTORS

(D) FOR SE TRACTORS ONLY

(E) HYDRAULIC PUMP 23/27 CM3

(F) POLLEN FILTER

FILTER OVERVIEW AND FUEL PUMP

PY000019

-UN-

6010

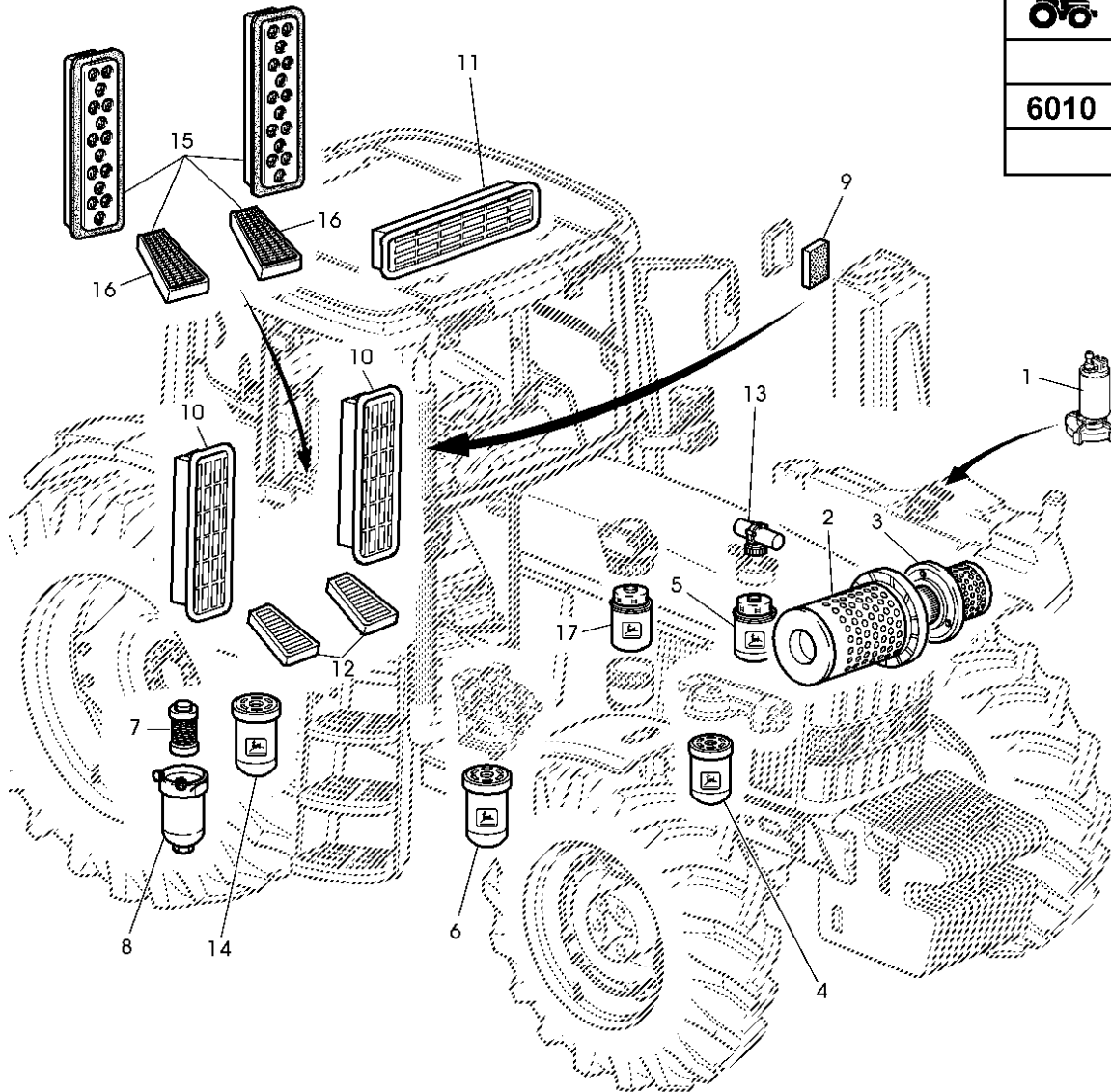

PY000019

KEY	PART NO.	PART NAME	QTY.	TRACTOR SERIAL NO.	4 6 C C Y Y L L	REMARKS
1	AL78405	FUEL PUMP	1		X X	
2	AL78223	FILTER ELEMENT	1		X	
	AL78869	FILTER ELEMENT	1		X	
3	AL78224	AIR FILTER	1		X	
	AL78870	FILTER ELEMENT	1		X	
4	RE59754	OIL FILTER	1		X X	
5	RE62419	FILTER ELEMENT	1		X X	(SUB FOR RE62418 APPL)
6	AL156625	OIL FILTER	1		X X	LGTH=158MM, FRONT (SUB FOR AL77061)
	AL156624	OIL FILTER	1		X	LGTH=120MM, FRONT (SUB FOR RE55801)
	AL118321	FILTER ELEMENT	1		X X	AUTOPOWR/JD-IVT (SUB FOR AL151235)
7	AL203060	OIL FILTER	1		X X	(G) LGTH=205MM (SUB FOR AL113475, AL113474, AL112936)
	AL118321	FILTER ELEMENT	1		X X	(A)
8	AL203520	OIL FILTER	1		X X	(G) LGTH=240MM (SUB FOR AL112922)
	L115579	FILTER HOUSING	1		X X	(A)
9	L101794	FILTER ELEMENT	2		X X	(B)
10	AL177185	AIR FILTER	2		X X	(E) (C) (SUB FOR AL111748, AL115625, AL119096)
	AL177184	AIR FILTER	2		X X	(C) (SUB FOR AL119095)
11	AL177185	AIR FILTER	1		X X	(D) (E) (SUB FOR AL111748, AL115625, AL119096)
	AL177184	AIR FILTER	1		X X	(D) (SUB FOR AL119095)
12	AL71259	FILTER ELEMENT	1		X X	
13	RE509530	KIT	1		X X	(F)
14	AL118036	HYDRAULIC FILTER	1		X X	REAR, (SUB FOR RE34958 APPL)
15	AL158985	ACTIVATED CARBON AIR FILTER	1		X X	KIT (SUB FOR AL158991)
16	L156235	ACTIVATED CARBON AIR FILTER	1		X X	LH
	L156236	ACTIVATED CARBON AIR FILTER	1		X X	RH
17	RE517181	FUEL FILTER	1		X X	(ORD RE509208)
	RE509208	FILTER ELEMENT	1		X X	(ALSO ORDER R113565)
	AL153517	FUEL FILTER	1		X X	(H)

(A) WITH HYDRAULIC PUMP 25CM3

(B) WITH AIR CONDITIONING

(C) ORDER AS PAIR

(D) ONLY FOR SE TRACTORS AND TRACTORS FOR NA 6405/6605 WITH CAB

(E) POLLEN FILTER

(F) ENGINE WITH BOSCH VP44 INJECTION PUMP

(G) WITH HYDRAULIC PUMP 23CM3 / 27CM3

(H) WITH BOSCH VP44 INJECTION PUMP

FILTER OVERVIEW AND FUEL PUMP

PY000020

-UN-

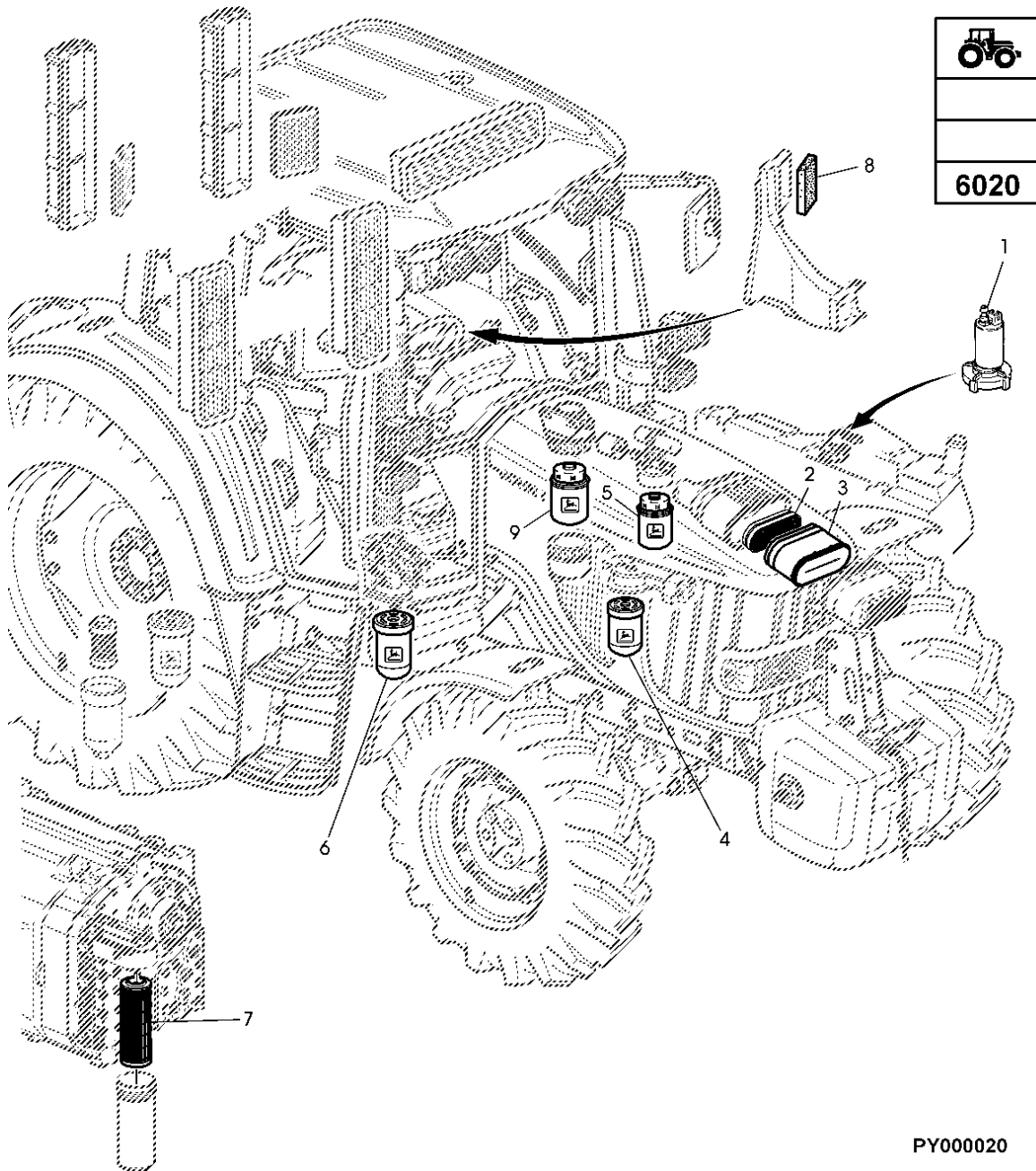

PY000020

KEY	PART NO.	PART NAME	QTY.	TRACTOR SERIAL NO.	4 C Y L	REMARKS
1	AL78405	FUEL PUMP	1		X	
2	AL150288	AIR FILTER	1		X	
3	AL172780	AIR FILTER	1		X	LGTH=183MM (7-7/32") (SUB FOR AL119839)
4	RE504836	OIL FILTER	1		X	(SUB FOR RE507522)
5	RE62419	FILTER ELEMENT	1		X	(B) (H) (G) (SUB FOR RE62418 APPL)
	RE509031	FUEL FILTER	1		X	(B) (E) (F)
6	AL156625	OIL FILTER	1		X	LGTH=158MM (SUB FOR RE55801)
7	AL118321	FILTER ELEMENT	1		X	AUTOPOWR/JD-IVT (SUB FOR AL151235)
8	L155288	FILTER	2		X	(C) (D) (SUB FOR L116025)
	L152026	FILTER ELEMENT	2		X	(D)
9	RE509208	FILTER ELEMENT	1		X	(A) (E) (F) (G) (H) (SUB FOR RE517181)

(A) PRIMARY FUEL FILTER

(B) FINAL FUEL FILTER

(C) WITH AIR CONDITIONING

(D) NOT FOR SE-TRACTORS

(F) FOR ENGINE 4045HL472/4045HL473/4045HL474/4045HL475/4045HL476

(E) FOR ENGINE 4045TL270/4045TL271/4045TL272/4045HL270/4045HL271/4045HL272/4045HL273

(H) FOR ENGINE 4045HLA70/4045HLA72/4045HLA73/4045HL072/4045HL070/4045HL270/4045HL271

(G) FOR ENGINE 4045DL070/4045TL070/4045TL071/4045TL072/4045TL073/4045TL064/4045TL271/4045TL272

FILTER OVERVIEW AND FUEL PUMP

PY000020

-UN-

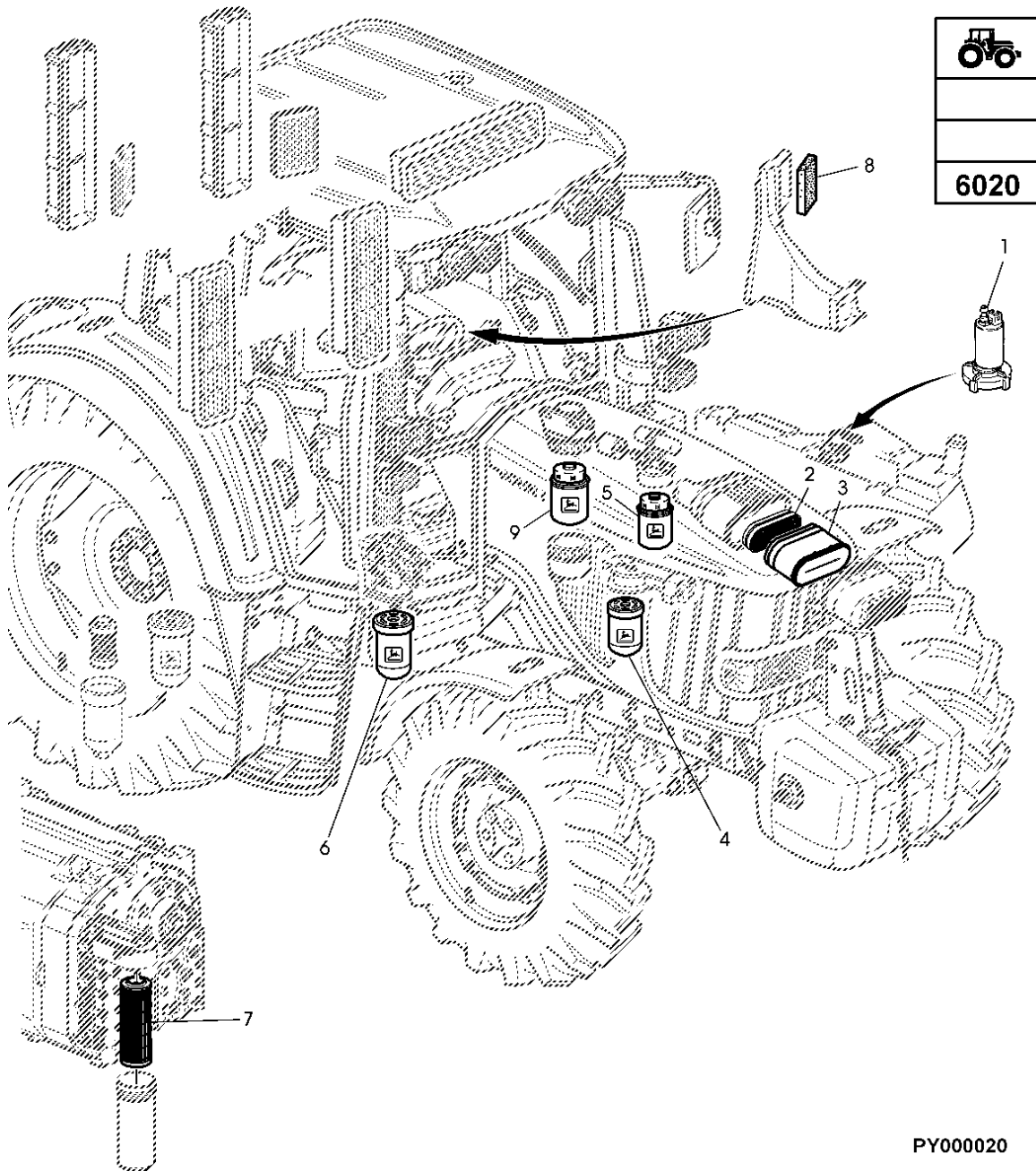

PY000020

KEY	PART NO.	PART NAME	QTY.	TRACTOR SERIAL NO.	6 C Y L	REMARKS
1	AL78405	FUEL PUMP	1		X	
2	AL150288	AIR FILTER	1		X	
3	AL172781	AIR FILTER	1	-391078	X	LGTH=284MM (11-3/16") ONLY 6520, 6620 (SUB FOR AL150285)
	AL172780	AIR FILTER	1	391079-	X	LGTH=183MM (7-7/32") ONLY 6520, 6620 (SUB FOR AL119839)
	AL172781	AIR FILTER	1		X	LGTH=284MM (11-3/16") ONLY 6820, 6920, 6920S (SUB FOR AL150285)
4	RE504836	OIL FILTER	1		X	(SUB FOR RE507522)
5	RE62419	FILTER ELEMENT	1		X	(B) (F) (SUB FOR RE62418 APPL)
	RE509031	FUEL FILTER	1		X	(B) (E)
	RE509032	FUEL FILTER	1		X	(B) (G)
6	AL156625	OIL FILTER	1		X	LGTH=158MM (SUB FOR RE55801)
	AL156624	OIL FILTER	1		X	LGTH=120MM (SUB FOR AL77061)
7	AL118321	FILTER ELEMENT	1		X	AUTOPOWR/JD-IVT (SUB FOR AL151235)
8	L155288	FILTER	2		X	(C) (D) (SUB FOR L116025)
	L152026	FILTER ELEMENT	2		X	(D)
9	RE509208	FILTER ELEMENT	1		X	(A) (E) (F) (SUB FOR RE517181)
	RE509036	FUEL FILTER	1		X	(A) (G) (SUB FOR RE517180)

(A) PRIMARY FUEL FILTER

(B) FINAL FUEL FILTER

(C) WITH AIR CONDITIONING

(D) NOT FOR SE-TRACTORS

(E) FOR ENGINE 6068HL270/6068HL271/6068HL272/6068HL273

(F) FOR ENGINE 6068DL070/6068DL071/6068TL072/6068TL073/6068HLA70/6068HLA71/6068HLA72/6068HLA73

(G) FOR ENGINE 6068HL470/6068HL471/6068HL472/6068HL473/6068HL474/6068HL475

FILTER OVERVIEW AND FUEL PUMP

PY000021

-UN-

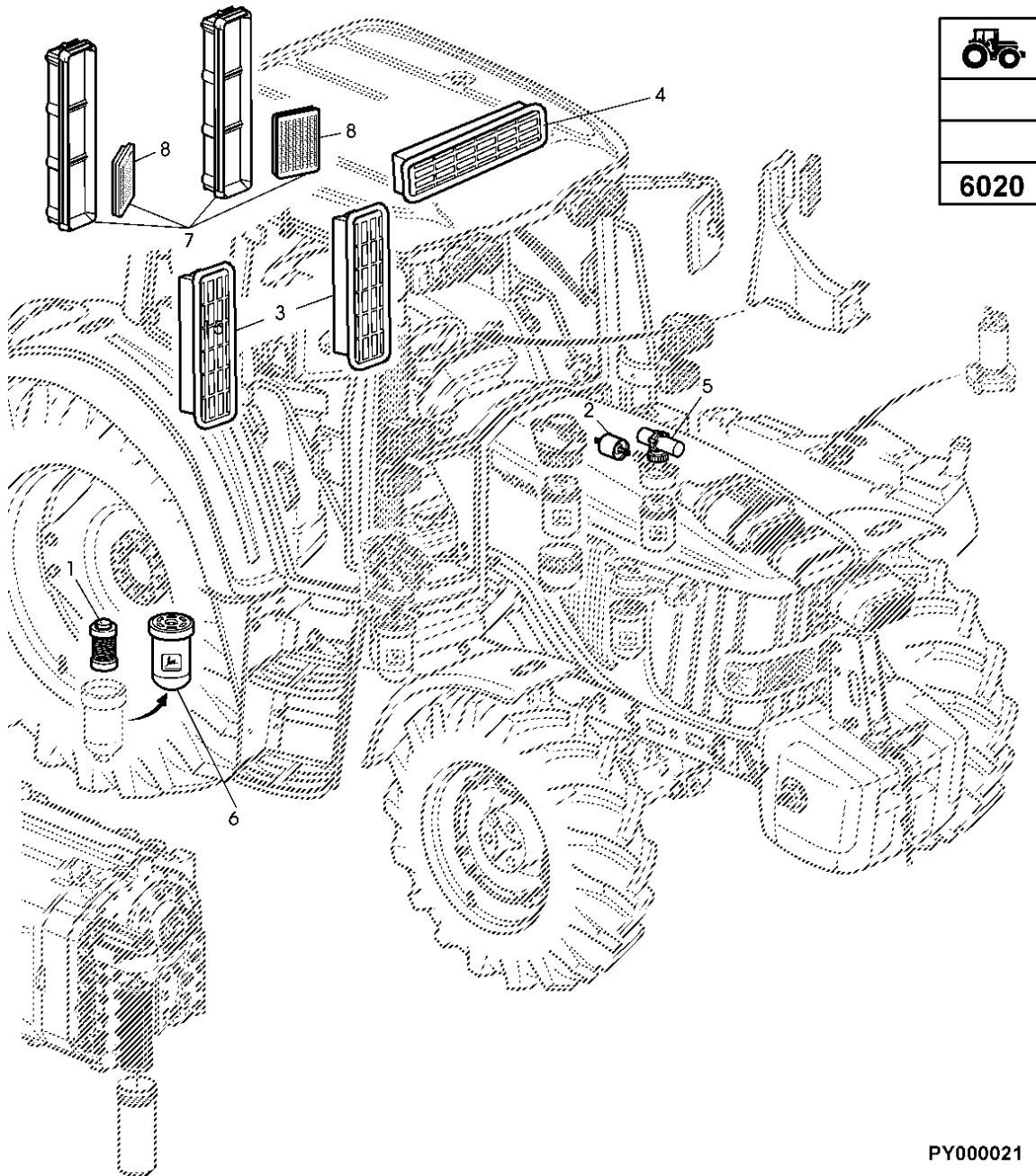

PY000021

KEY	PART NO.	PART NAME	QTY.	SERIAL NO.	4 6 C C Y Y L L	REMARKS
1	AL203060	OIL FILTER	1	-366729	X X	(B) (F) (SUB FOR AL112936)
	AL118321	FILTER ELEMENT	1	-376493	X X	(E)
	AL203061	OIL FILTER	1	376494-	X X	(E) (SUB FOR AL160771)
	AL203061	OIL FILTER	1	366730-	X X	(B) (F) (SUB FOR AL160771)
2	AL153517	FUEL FILTER	1		X X	(D)
3	AL177185	AIR FILTER	2		X X	(E) (SUB FOR AL111748, AL115625, AL119096)
	AL177184	AIR FILTER	2		X X	(SUB FOR AL119095)
4	AL177185	AIR FILTER	1		X X	(E) (G) (SUB FOR AL111748, AL115625, AL119096)
	AL177184	AIR FILTER	1		X X	(SUB FOR AL119095)
5	RE509530	KIT	1		X	(D)
6	AL118036	HYDRAULIC FILTER	1		X X	(C) (F) REAR
7	AL158986	ACTIVATED CARBON AIR FILTER	1		X X	KIT
8	L156225	ACTIVATED CARBON AIR FILTER	2		X X	
..	AL159178	KIT	1		X X	(A) (ORD W/ AL158986)

(A) FIRST INSTALLATION KIT

(B) WITH HYDR. PUMP 23 / 27CM3

(C) WITH HYDR. PUMP 25 / 41CM3

(D) USE WITH BOSCH VP44 INJECTION PUMP ONLY

(E) WITH AUTOPOWER

(F) WITHOUT AUTOPOWER

(G) WITH TRACTORS 6215, 6415, 6616 AND 6715 TRACTORS FOR NA

John Deere Part - the better part!

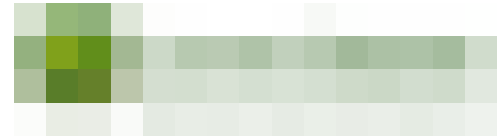

Genuine John Deere Filter and fake - of the same quality standard? See the difference!

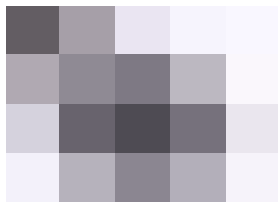
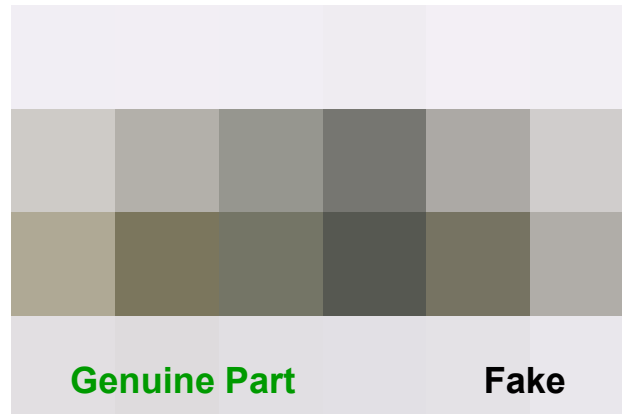

A seal guarantees a reliable filtration at the John Deere filter.

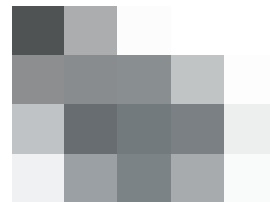

The fake has no seal to prevent the blending of dirty and filtered oil.

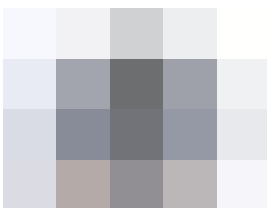

The genuine part incorporates a spring giving correct spring pressure and and superior filtration.

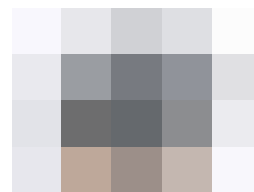

Lower spring pressure little spring displacement and an unspecific figuration of the spring provoke a inferior filtration.

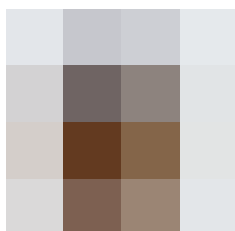

High quality filter paper has a higher density which lets no light through - as the John Deere quality standard requires!

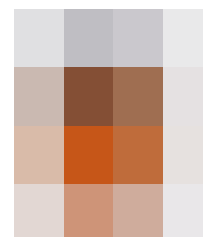

Inferior filter paper is more permeable to particles which can easily be proven by a light test.

John Deere Part - the better part!

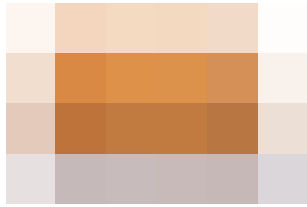
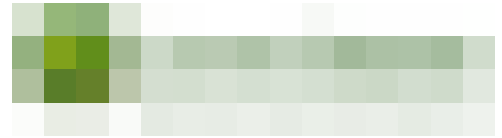

If you press the paper you see that John Deere uses premium paper. In pressed condition it is 50% longer than the fake. This results in a stronger paper that is crimped to support an equal filtration and a larger surface.

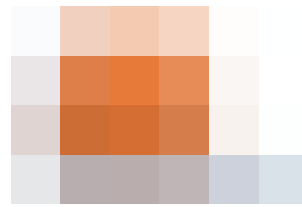

The paper of the fake is not crimped so that folds can pool together. The subsequent filtration will be very unequal.

Don't endanger the reliability and productivity of your tractor with a „fake“ through:

- Brummagem paper
 - Stiff paper
 - Non-specific spring
 - No sealing
- ⇒ Less efficient filtration has bad impact on the reliability and lifetime of your material!

Therefore benefit from the quality advantages of the „Genuine Part“:

- + Dense paper
- + Crimped soft paper
- + Special spring
- + Effective head sealing

**Decide on the Genuine JOHN DEERE quality standards -
Contact your JOHN DEERE Dealer!**